

Auto+Sanitizer Dispensers Installation (2L-U3011)

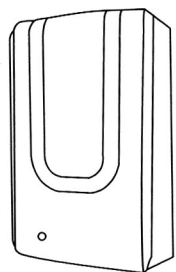

1X*
1200ml

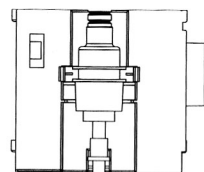

1 gears dispensing 0.6ml
2 gears dispensing 1.2ml
3 gears dispensing 1.6ml



* we have different shape but same installation.

Packing List

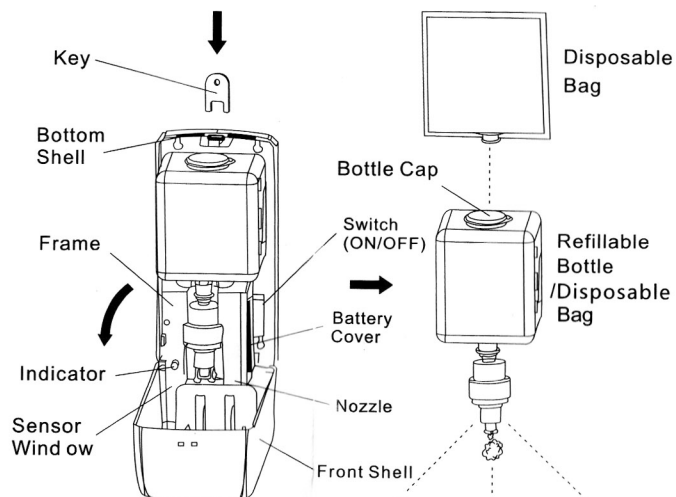

Different Pump for Different Liquid

1. Spray: Sanitizer Liquid;
2. Soap: Diluted Gel Soap;
3. Foam: Foam Liquid.

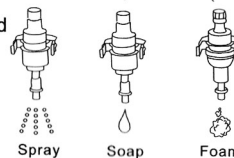

Part Name

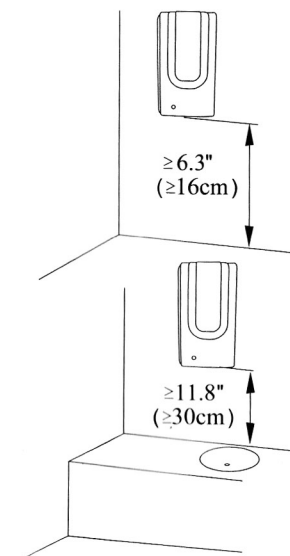

* keep away from sunshine and humid place

Height from Floor/Table

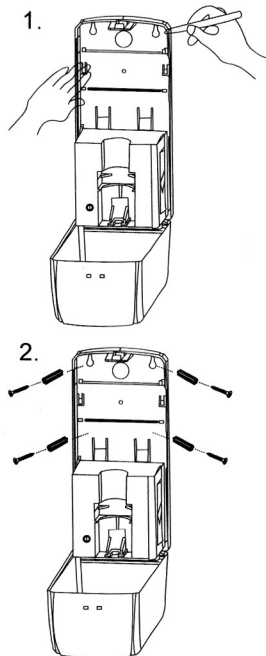

Way for Screw

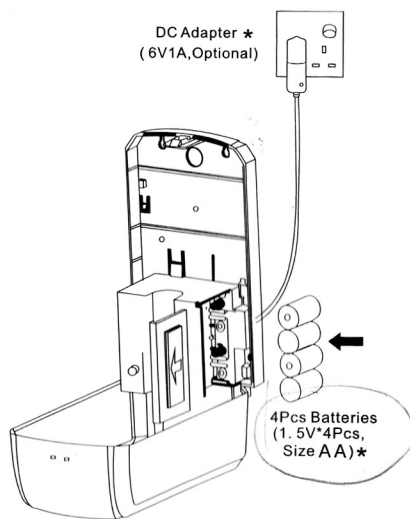

* The Standard Packing is not including DC Adapter and Batteries

Install Batteries/DC Adapter

1. Double-sided adhesive* (Optional)

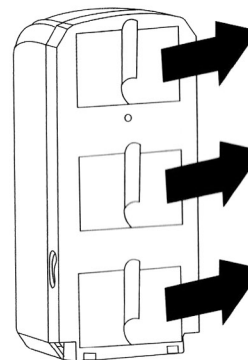

* The standard Packing is not including Double-sided adhesive and Silicone sealant

Installation with Adhesive Backing (no screws)

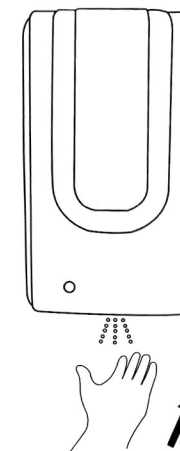

* LED Light:
Save 70% of battery

Enjoy hand sanitizing

Auto+Sanitizer Dispensers Installation (2L-U3011)

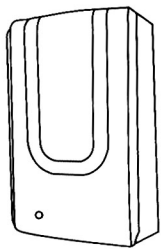

1X*
1200ml

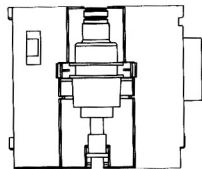

1 gears dispensing 0.6ml
2 gears dispensing 1.2ml
3 gears dispensing 1.6ml



we have different shape but same installation.

Packing List

1. Drill hole (6mm Drill), and insert plug

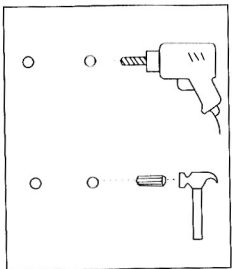

2. fix screw

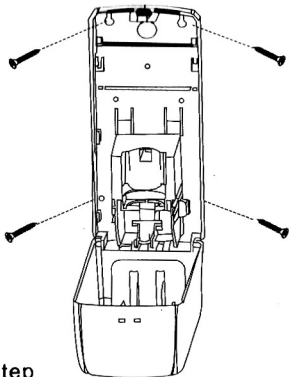

Kindly note:
Step 1, fill the reservoir. Step
Step 2, let the pump run 6 to 10 times
before use, so that there is no
more air in the pump. If it is empty,
repeat these steps.

Part Name

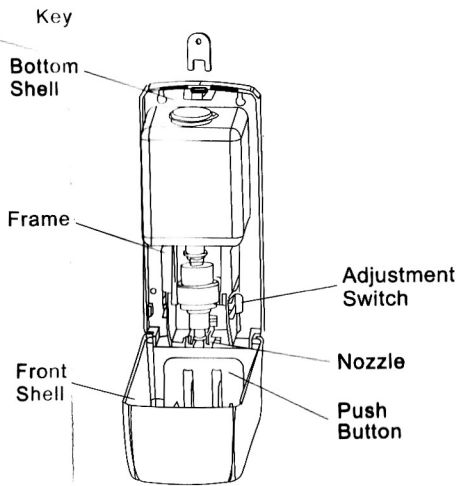

Different Pump for Different Liquid

- 1. Spray: Sanitizer Liquid;
- 2. Soap : Diluted Gel Soap;
- 3. Foam: Foam Liquid.

Part Name

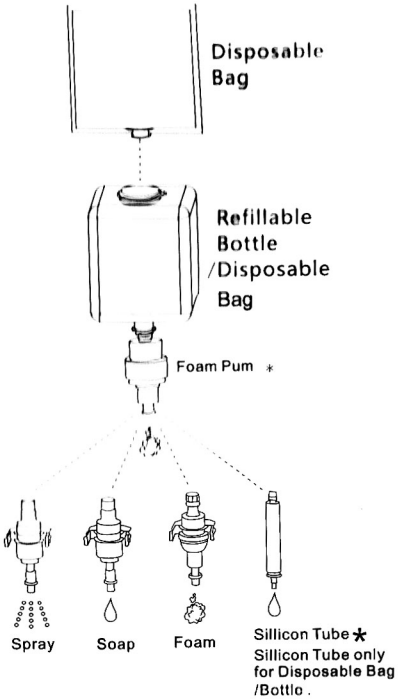

1. Double-sided adhesive (Optional)

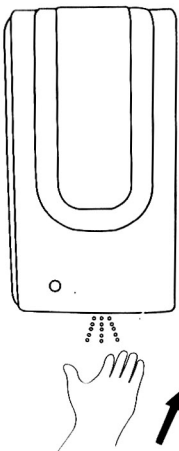
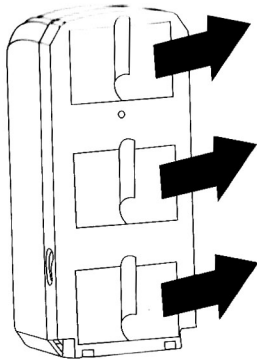

* The standard Packing is not including Double-sided adhesive and Silicone sealant

Way for Sticker/without Screw

Enjoy hand sanitizing